



UK SANSAR

ESTATE AGENCY



18 Cornflower Grove, Ketley, Telford, TF1 5ZH

£950

- 3 spacious bedrooms
- Charming house in Ketley
- Easy access to transport
- Quiet Cornflower Grove location
- 1 modern bathroom
- Built in 1999
- Ideal for families
- Cosy reception room
- Close to local amenities
- Viewing recommended

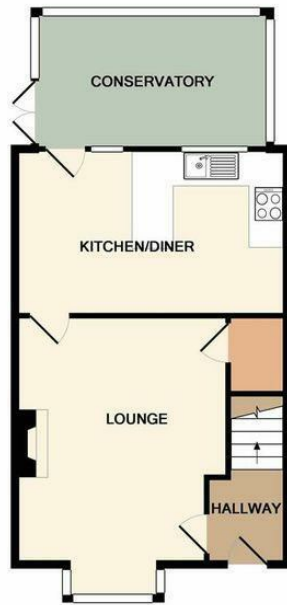

GROUND FLOOR

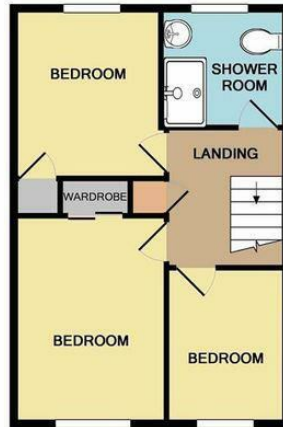

1ST FLOOR

Whilst every attempt has been made to ensure the accuracy of the floor plan contained here, measurements of doors, windows, rooms and any other items are approximate and no responsibility is taken for any error, omission, or mis-statement. This plan is for illustrative purposes only and should be used as such by any prospective purchaser. The services, systems and appliances shown have not been tested and no guarantee is given as to their operability or efficiency can be given.
Made with Metropix ©2017

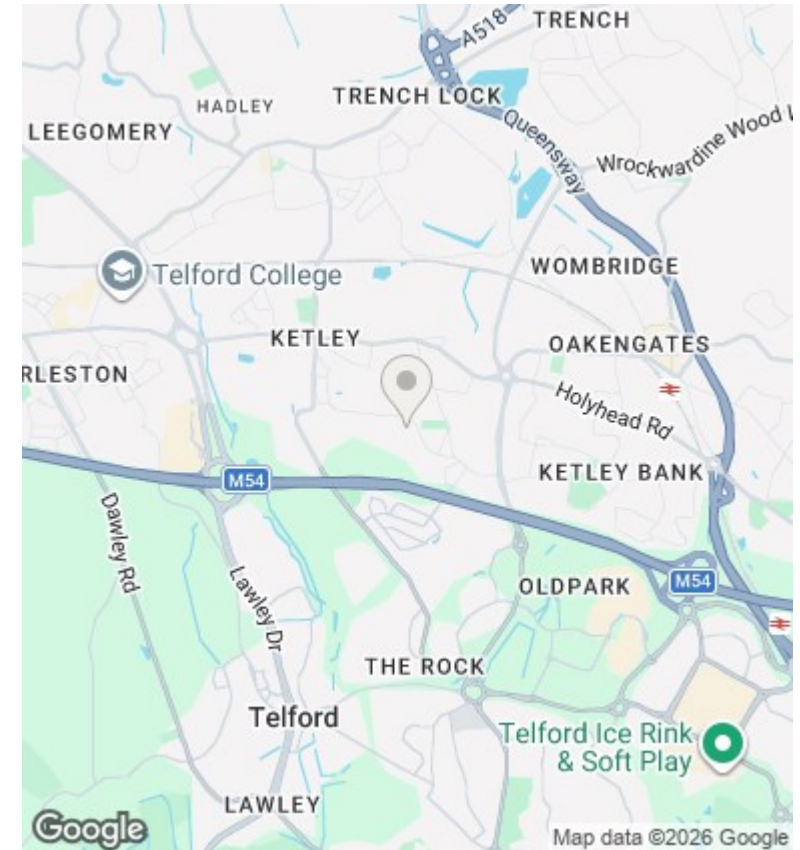

Directions

Viewings

Viewings by arrangement only.
Call 02046025871 to make an appointment.

Council Tax Band

B

EPC Rating:

C

Energy Efficiency Rating		
	Current	Potential
Very energy efficient - lower running costs		
(92 plus) A		
(81-91) B		85
(69-80) C	71	
(55-68) D		
(39-54) E		
(21-38) F		
(1-20) G		
Not energy efficient - higher running costs		
England & Wales	EU Directive 2002/91/EC	